

THORN

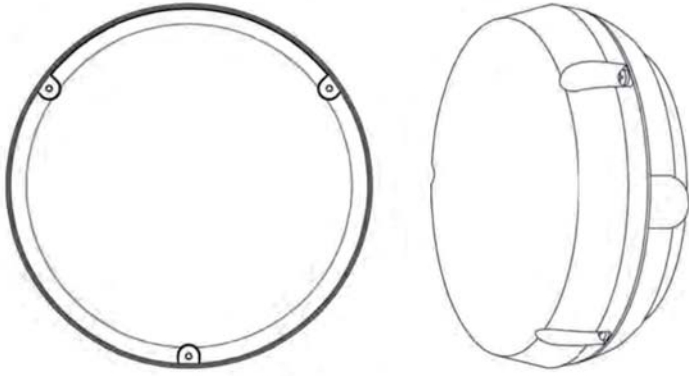

Leopard 900 / 1200 LED 2

CE

[CZ] Montážní návod
 [DE] Montageanleitung
 [DK] Monteringsvejledning
 [EE] Paigaldusjuhend
 [FI] Asennusohje
 [FR] Notice de montage
 [HU] Szerelési útmutató
 [IT] Istruzioni di montaggio

[LT] Montavimo Instrukcijos
 [LV] Instalācijas instrukcija
 [NO] Monteringsanvisning
 [PL] Instrukcja montażu
 [RU] Инструкция по монтажу
 [SE] Installationsanvisning
 [UK] Installation Instructions

96350913 PB

11/15

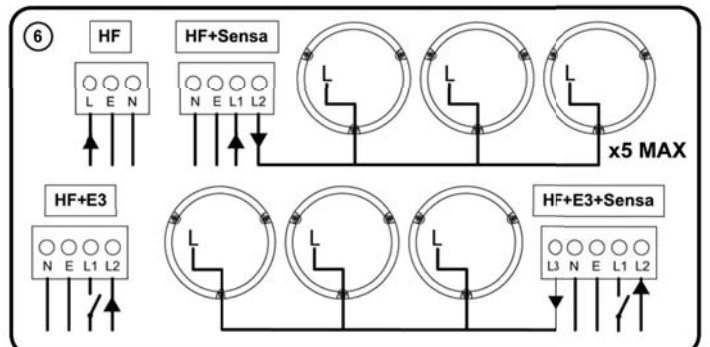
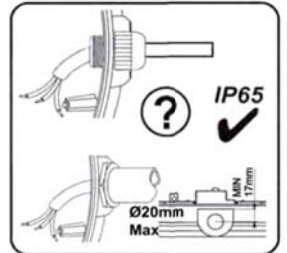
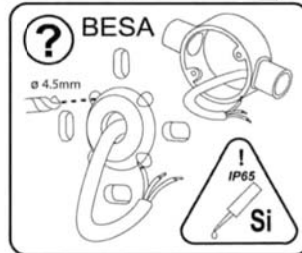
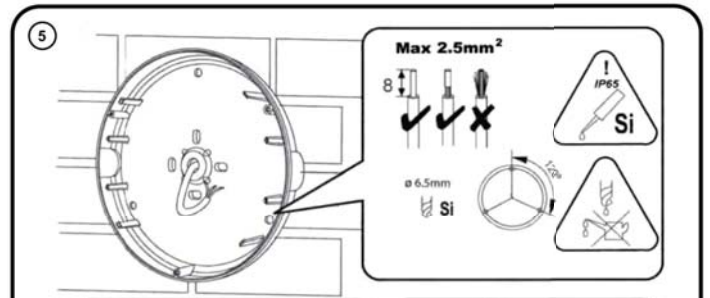
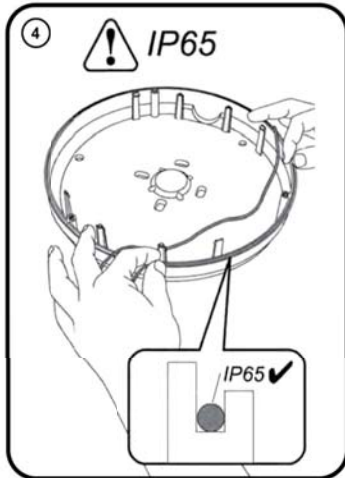
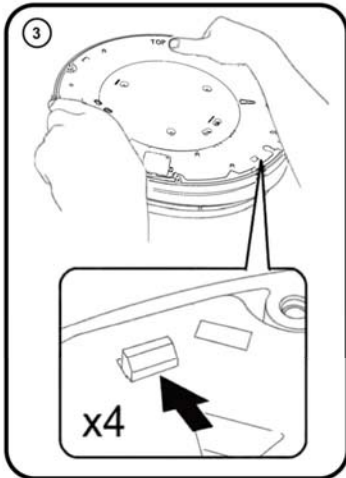
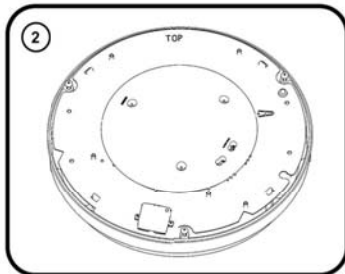
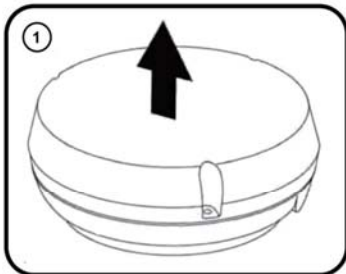
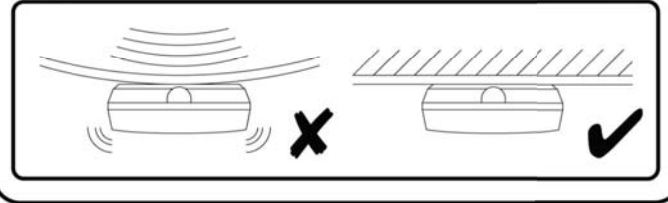
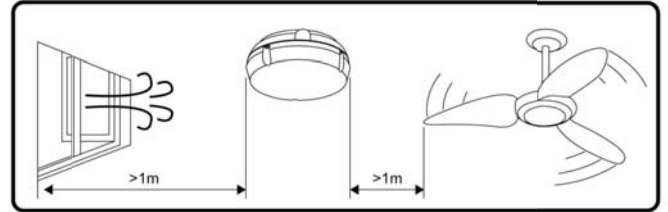
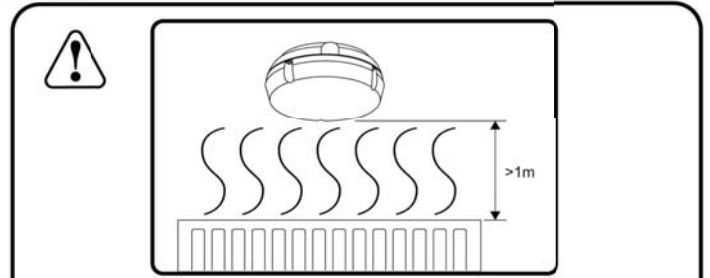
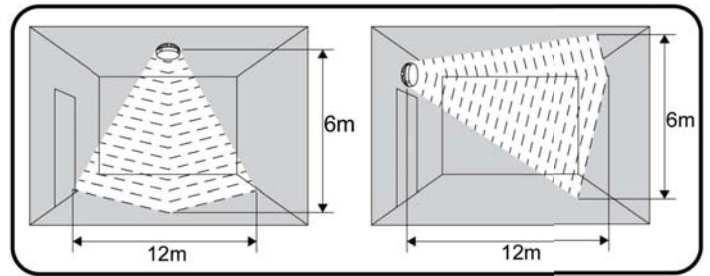

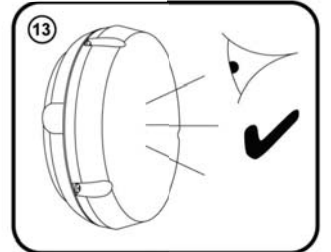
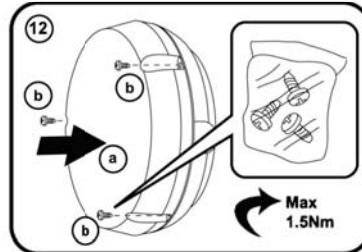
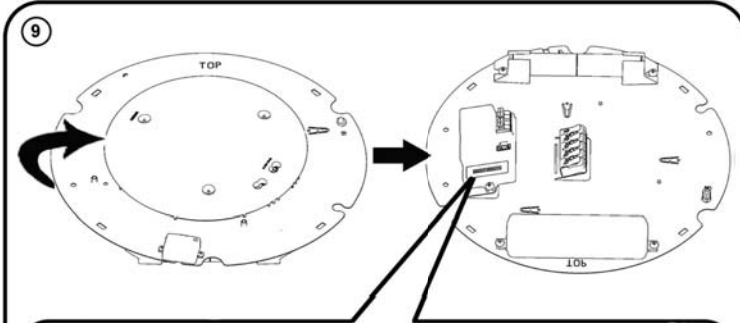
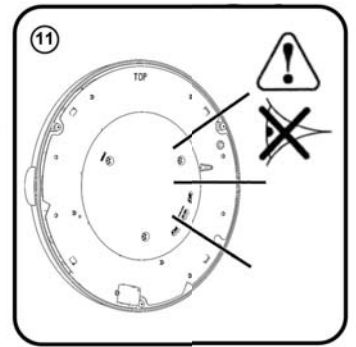
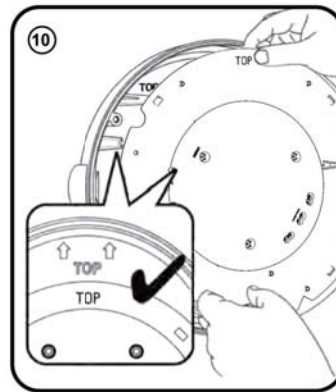
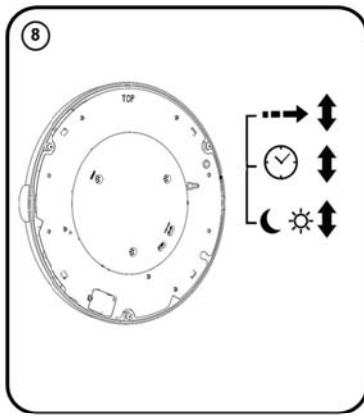
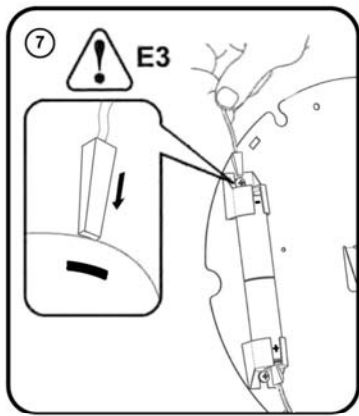

i

DEFAULT 100%
DÉFAUT 6min
STANDARD Disabled

1 2 3	1 2 3 4	1 2 3 4

Detection Area	1	2	3	
I	●	●	●	100%
II	●	○	●	75%
III	○	○	●	50%
IV	○	●	○	25%
V	●	○	○	10%

Hold Time	1	2	3	4	
I	●	●	●	●	30min
II	○	○	○	●	20min
III	○	○	○	○	6min
IV	○	●	○	○	90s
V	●	○	○	○	30s
VI	○	○	○	○	10s

Daylight Sensor	1	2	3	4	
I	●	●	●	●	Disabled
II	○	○	●	○	50 lux
III	○	○	○	○	30 lux
IV	●	○	○	○	10 lux
V	○	○	○	○	5 lux

